

# Instruction manual



THS 1000  
1 x 63W RMS  
CLASS D



The installation of this product must be made by a qualified professional.

# Index

- 01 • Introduction
  - Presentation
- 02 • Important recommendations
  - Audio source
  - Package content
- 03 • Front panel
- 04 • Front panel (cont'd)
  - Rear panel
- 05 • Remote control function
- 06 • Bluetooth
  - Bluetooth use example
  - RCA use example
- 07 • Connection examples - Ceiling speaker
  - Term of warranty
  - Technical assistance
- 08 • Technical features

## Introduction

Congratulations on purchasing a Taramps product.

Developed in a modern laboratory, with highest technology and highly qualified professionals.

This manual explains all the resources, operations and guidelines for resolving questions that may arise in your installation. Take a time to read it carefully and ensure the proper installation and use of all the benefits that this product can offer.

In case of doubt even after reading this manual, please contact our technical support at the number **+55 18 3266 4050** or our website **[www.taramps.com.br](http://www.taramps.com.br)**.

## Presentation

The **THS 1000** is a Receiver developed with high technology to integrate different environments. Compact and powerful it can be used in several applications providing quality sound.

Application examples:

- Environment sound for stores, shops and clinics. It also allows, through the microphone input, that warnings are transmitted via the sound system.
- In your leisure area, gourmet space, country house, etc. Including various audio input options, such as Bluetooth, AUX, MICRO SD CARD and USB, it allows the audio sources to be easily changed giving the user flexibility in choosing the preferred audio.

The equipment is automatic bivolt and can be connected to any power plug between 90 and 240V. It has a switching power supply that is more efficient in the consumption of electricity.

If you are not going to use the product for a long time, we recommend that you disconnect from the power plug.

# Important recommendations

- The THS 1000 must be installed in a firm and ventilated place, away from heat and humidity places. Avoid locations with direct sunlight.
- Do not block the ventilation holes on the top and rear.
- Avoid falls and impacts.
- Carefully observe the polarity and impedance of the loudspeakers.
- Use cables according to the distance between the THS 1000 and the loudspeakers.

The table below shows the recommended gauges according to the distances:

Until 20m	cables with a gauge larger than or equal to	1 mm <sup>2</sup> (17AWG)
Until 40	cables with a gauge larger than or equal to	1,5 mm <sup>2</sup> (15 AWG)
Until 70m	cables with a gauge larger than or equal to	2,5 mm <sup>2</sup> (13 AWG)
Until 100m	cables with a gauge larger than or equal to	4 mm <sup>2</sup> (11 AWG)

- In case of unwanted noise make sure that the cables and connections are in good condition. Leave the volume to a minimum of unused channels.

## Audio source

The TARAMPS **THS 1000** has the following audio inputs:

1. USB: Flash drive input \*
2. MICRO SD CARD \*
3. AUX (front): P2 standard auxiliary input.
4. AUX: RCA standard auxiliary inputs.
5. BLUETOOTH
6. FM Radio

\* The connected device must contain music in MP3 format to be identified by the equipment.  
Maximum supported size: 64GB.

 We advise you to always have a good antivirus, so there are no problems with the Flash Drive or micro SD card when connecting to the product. Infected devices may cause undesirable effects to the THS 1000, such as: Slow music reading and general failures.

Do not use the USB input to connect to the computer or to recharge other devices that have batteries.

## Package content

- 01 Receiver Multi Channel THS 1000



- 01 Remote Control



- 01 Power supply 12V - 03A



- 01 Bluetooth Antenna



# Front panel

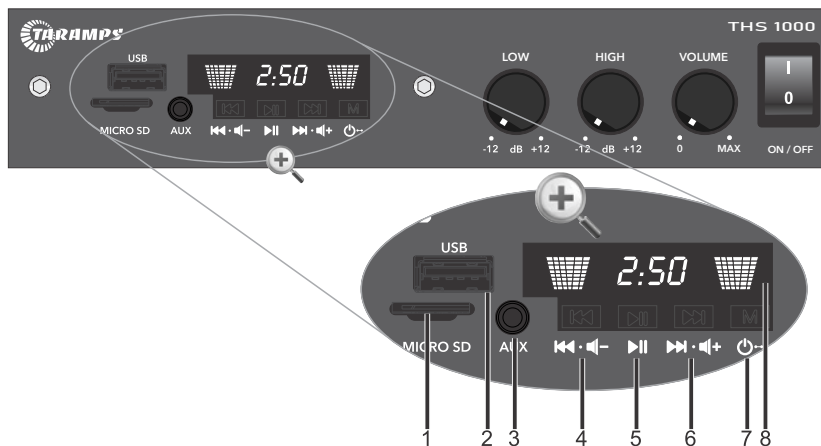

**1 - MICRO SD:** Micro SD memory card input.

The card must be positioned as the image shows, with the terminals facing up).

**2 - USB:** Flash Drive input.

**3 - Aux. (P2 Connector):** Receives audio signal from the P2 output of your phone, tablet, MP3, computer, among others. Use good quality cable to avoid unwanted noise.

**4 - Track - /Volume -:**

**Short Touch:** Rewind the music tracks in the USB/SD/BLUETOOTH. Reduce 0.1MHz of the frequency.

**Long Touch:** Reduce the volume in all sources options. Automatic search to previous stations.

**5 - Play / Pause:**

**Short Touch:** Pause or start the music on USB / SD / BLUETOOTH. Advances next saved memory position of FM stations.

Mute for AUXILIARY option.

**Long Touch:** Searches for FM stations and saves them in memory.

**6 - Track + /Volume +:**

**Short Touch:** Forward the music tracks in the USB/SD/ BLUETOOTH. Increase 0.1MHz of the frequency.

**Long Touch:** Increase the volume in all sources options. Automatic search to next stations.

**7 - Mode / ON/OFF:**

**Short Touch:** Changes the source options, such as: USB / SD / AUXILIARY / BLUETOOTH / FM.

**Long Touch:** To turn on or off the device.

**8 - LED Display - Remote control IR sensor:** For better communication between the remote control and the device, point the control at this point on the display.

## Front panel (cont'd)



**9 - STAND-BY LED:** Remains on when the equipment is turned off and plugged into a powered outlet.

**10 - EQUALIZATION:** 2 band audio equalizer adjust.

LOW: Bass frequencies

HIGH: High frequencies.

**11 - VOL:** Adjusts the output volume).

## Rear panel

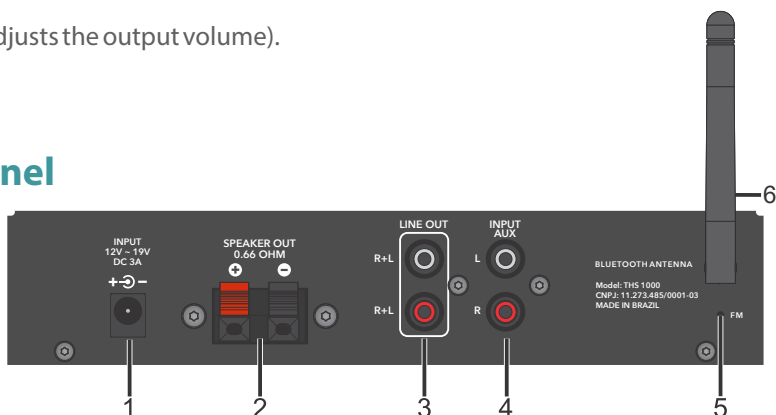

**1 - POWER CABLE:** Connect the original power supply that comes with the product.

Attention: It is not recommended to use power supplies with voltage and amperage outside the specified range.

**2 - SPEAKER OUT:** To connect the loudspeakers. Follow the indicated polarity and the recommended minimum impedance of 0.66 ohms.

**3 - LINE OUT:** The LINE OUT output allows you to send the audio signal (not amplified) to other equipment, such as a THS 3600, an active amplifier or subwoofer. This signal goes through the equipment's equalization settings (LOW and HIGH).

**4 - AUX INPUT:** L and R (RCA) input works in parallel with the front AUX input (connector P2).

**5 - FM ANTENNA:** Indoor wire antenna for FM radio reception. Position the wire antenna in order to achieve the best FM reception.

**6 - BLUETOOTH ANTENNA:** External antenna to improve Bluetooth range reception.

## Remote control functions

The THS 1000 has a compact remote control, so you can remotely control the device with practicality.



 **ON / OFF:** Press the key to turn off the device.

 **MODE:** Switch the audio source (USB, BLUETOOTH, SD, AUXILIARY, FM).

 **MUTE**

 **PLAY / PAUSE:** Pause or start the music to USB / SD / BLUETOOTH.

**FM: Short Press:** Advances next saved memory location of FM stations.

**Long Press:** Searches for FM stations and saves them in memory.



**TRACK - / FOLDER - / FM-:**

**TRACK** - Rewind the music track (short press)

**FOLDER** - Go back to the previous folder (long press)

**FM: Short Press:** Previous 0.1MHz of the frequency. Previous track

**Long Press:** Previous folder. Automatic search to the previous station.



**TRACK + / FOLDER + / FM+:**

**TRACK** - Advance the music track (short press)

**FOLDER** - Advance the folder

**Short Press:** Next 0.1MHz of the frequency. Next track

**Long Press:** Automatic search to the next station. Next folder



**EQUALIZATION:** Pop / Rock / Jazz / Country / Normal.

Do not work in auxiliary mode.

**FM:** Short Press Return to the saved memory position of FM stations.



**VOL-:** Volume down



**VOL+:** Volume up



**REPEAT:** Repeat / play MP3 options

**OBS:** The SNC, REC and STOP keys have function

## Bluetooth

When selecting the Bluetooth function (identified with "bt" on the display), the THS 1000 waits for a Bluetooth connection. Search for the device called "TARAMPS" using your phone, tablet, PC or other and match it.

- To connect to a new device, disconnect the current one and make the new Bluetooth pairing.

Bluetooth specification: class II with a 50m maximum range and may vary according to the environment (such as walls) and the connected device.

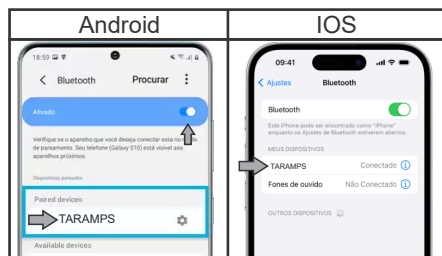

For other devices the connection system is similar (consult manufacturer's manual)

## Bluetooth use example

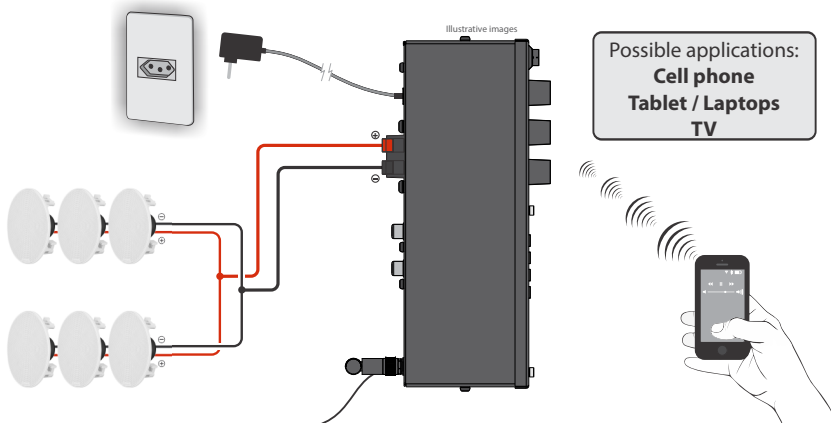

Some TVs have an audio output system via Bluetooth. If your TV has this feature, it's possible to transmit the audio to the THS 1000.

Consult your TV manufacturer's manual.

## RCA use example

Select the AUX function on the "MODE" key.

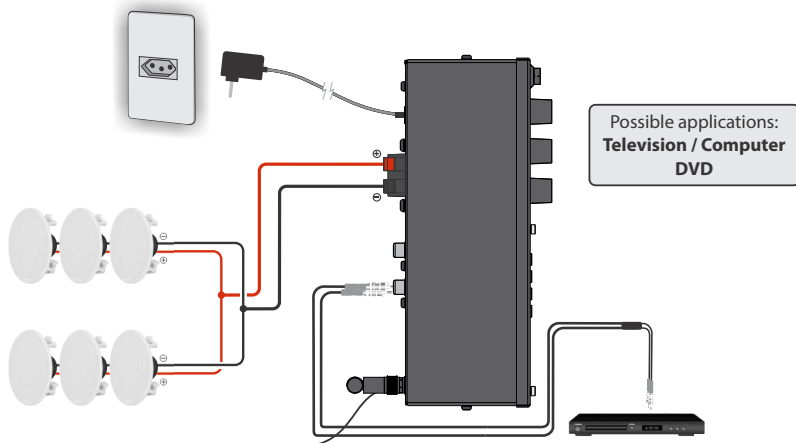

# Connection examples - Ceiling speaker

## Example for up to 12 ceiling speakers of 8 ohms

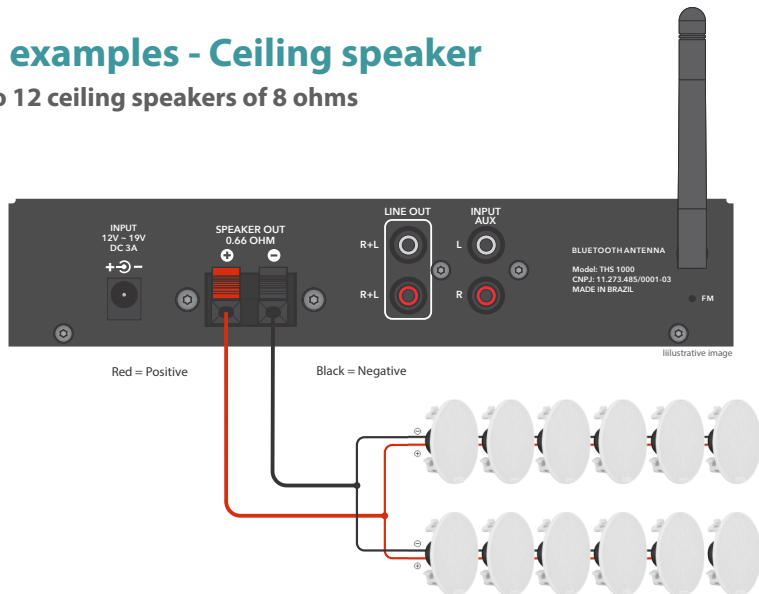

For this kind of connection use cables with a minimum gauge of  $1.5\text{mm}^2$  for up to 40 meters. For long distances, consult the table on page 02 "Important recommendations". It's necessary to make connections in parallel and series as shown in the example, to match impedance.

### Term of warranty

A TARAMPS, localizada à Rodovia Júlio Budisk, SN, KM 30 - Alfredo Marcondes - SP, CEP 19.180-120, garante este produto contra defeitos de projeto, fabricação, montagem e/ou solidariamente em decorrência de vícios de projeto que o torne impróprio ou inadequado ao uso a que se destina, pelo prazo de 12 meses, a partir da data de aquisição.

Em caso de defeito no período de garantia, a responsabilidade da TARAMPS limita-se ao conserto ou substituição do aparelho de sua fabricação.

#### Esta garantia exclui:

- Produtos danificados por instalação incorreta, infiltração de água, violação por pessoas não autorizadas;
- Lacre de garantia rasurado ou rasgado;
- Casos onde o produto não seja utilizado em condições normais;
- Defeitos provocados por acessórios, modificações ou equipamentos acoplados ao produto;
- O produto apresentar danos decorrentes de quedas, impactos ou da ação de agentes da natureza (inundações, raios, etc.);
- Custos de retirada e reinstalação do equipamento, bem como seu transporte até o posto de assistência técnica;
- Danos de qualquer natureza, consequentes de problemas no produto, bem como perdas causadas pela interrupção do uso.

### Technical assistance

For international support, check on our website:

[www.taramps.com.br/en/rede-de-assistencias-tecnicas](http://www.taramps.com.br/en/rede-de-assistencias-tecnicas) or contact direct the factory support:

Phones: +55 18 3266-4050 / +55 18 99749-3391

E-mail: [service@taramps.com.br](mailto:service@taramps.com.br)



## Technical features

TARAMPS THS 1000:_____	Receiver Mono Channel Class D
Number of Channels:_____	01
RMS Power:_____	63W
Each channel nominal Impedance_____	0.66 Ohm
AUX input Sensitivity:_____	200 mV
AUX Input impedance:_____	10K Ohm
Frequency response (equalizers at 0dB):_____	20Hz ~ 20KHz (-3dB)
Typical 2-way equalizer performance: Low (bass):_____	± 15dB - 100Hz
High:_____	± 15dB - 5KHz
Power Supply:_____	100 ~ 240V AC
Consumption in Stand by:_____	1.4W
Maximum consumption:_____	115W
Protection System:_____	Output protection against short and overheating
Ratio signal/noise:_____	>70dB
FM frequencies:_____	87.5 MHz ~ 108MHz
Dimensions:_____	204 x 44 x 119mm (8.03" x 1.73" x 4.7")
Weight of product:_____	0.45Kg (0.99lb)
Weight of AC Adapter:_____	0.10Kg (0.22lb)

The values mentioned are typical and may change due to the tolerance of components or the manufacturing process.

For more information or questions visit our website or contact TARAMPS support.



Taramps reserves the right to modify the contents of this manual without prior notice and not to apply the modifications to units previously produced.



+55 18 3266-4050

Manufactured by:  
TARAMPS ELECTRONICS LTDA  
TAX ID: 11.273.485/0001-03  
Júlio Budisk RD, SN, KM 30  
Alfredo Marcondes - SP  
Made in Brazil  
[www.taramps.com.br](http://www.taramps.com.br)